

## Revolution 360 - Centrifugal Single-inlet Forward Curved Single Inlet 120mm

### Technical Data

Supply (V/Ph/Hz)	//
Max Airflow (m³/h)	314
Max Current (A)	0.6
Max Input Power (W)	59
Max Speed (rpm)	3600
ErP Efficiency Rating (FMEG)	56
Ip Rating	54
Motor Insulation Class	b
Temperature Range (°C)	-20 to +60
Weight (KG)	1.6

### Performance Data

Data Point	Static Pressure (pa)	Airflow (m³/h)	Current (A)	Speed (rpm)	Power (W)
1	546	0	0.39	3609	36
2	515	103	0.50	3605	50
3	394	168	0.52	3135	52
4	211	250	0.55	2557	55
5	0	314	0.58	2184	59

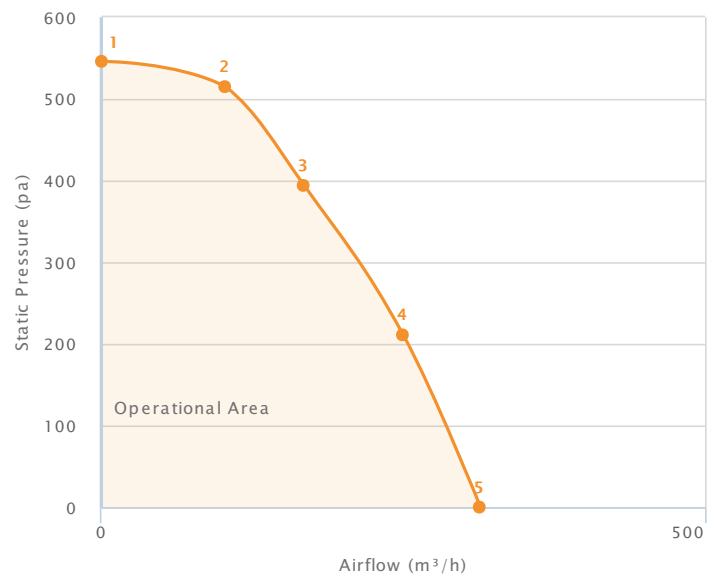

- Tested in accordance with ISO 5801
- Installation type method - type A

### Dimensions

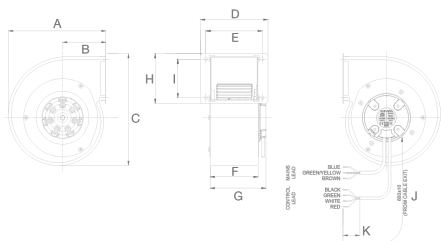

A	173	G	99
B	77	H	88
C	197.8	I	68
D	120	J	600
E	100	K	30
F	85	L	